

## M 1:25

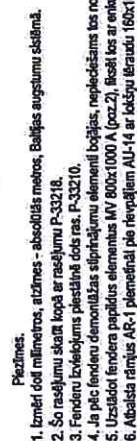

Elementa marķa	Poz. Nr.	Aprakojums	Nosaukums	Daudz.	Masa, kg.		Piezīmes
					1poz.	2vis.	
Fenders	1		Fenderu elements MV 800x1000 A	1			esotais elements
	2		Fenderu elements MV 800x1000 A	2			esotais elements
	3	MEL 644 KN	Kādes (london chain) DIA 32 L=640	4			esotais elements
	4	MEL 424 KN	Kādes (weight chain) DIA 26 L=352	2			esotais elements
	5	8,8 HDG	Enkurbulskrievs K36x310	6			stamā 4, piecīnī
	6	HDG	Papilduskrīevs 203x66x5	12			stamā 4, piecīnī
	7	8,8 HDG	Ungriezis DIN 934 M36	12			stamā 4, piecīnī
	8	8,8 HDG	Enkurbulskrievs K36x60	6			stamā 4, piecīnī
	9	HDG	Papilduskrīevs 240x66x5	1			stamā 4, piecīnī
	10	UHMW-PE	Pelē 300x2000x3900	6			esotais elements
				KOPĀ:			

[illegible]



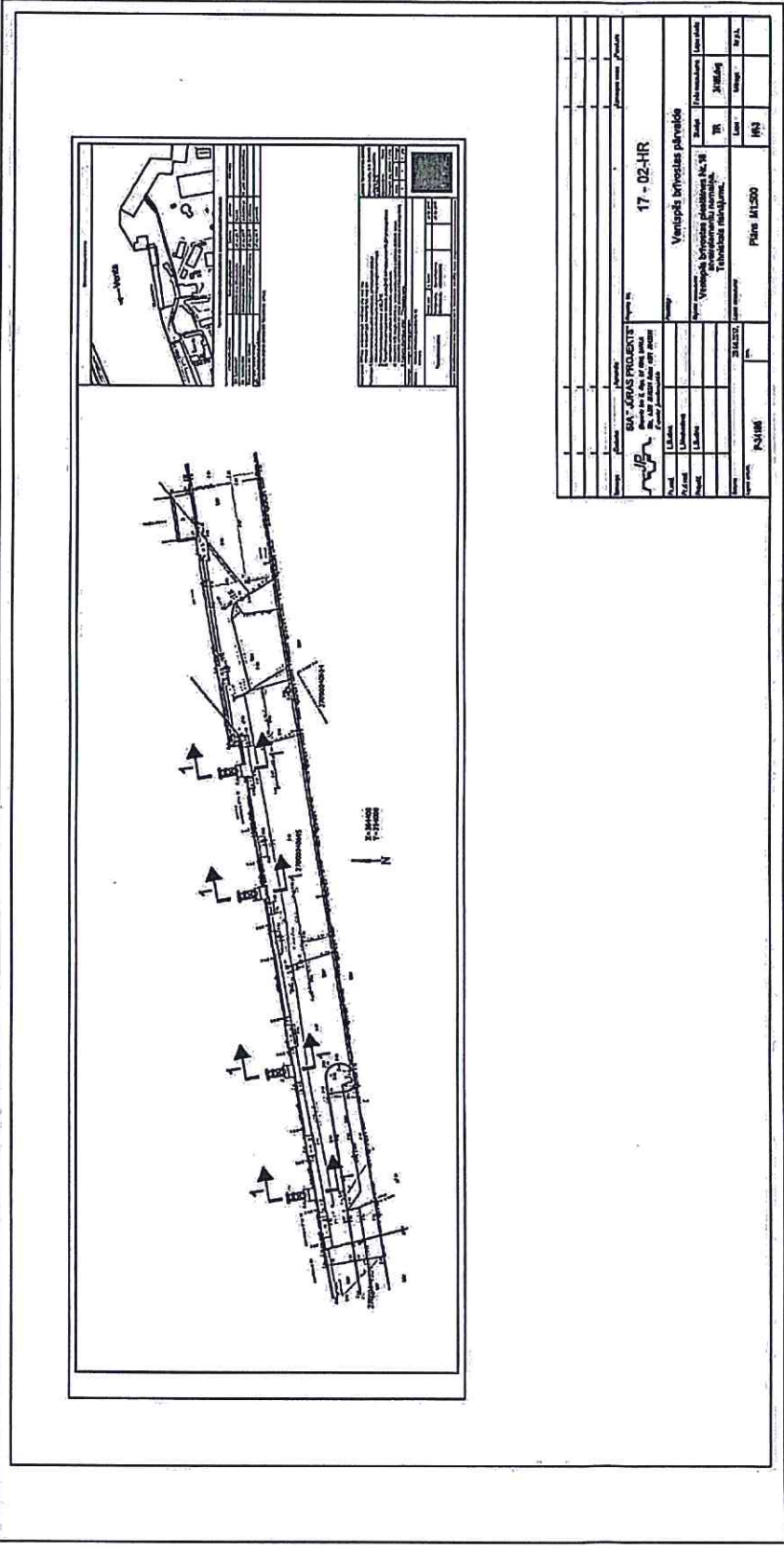

[illegible][illegible]



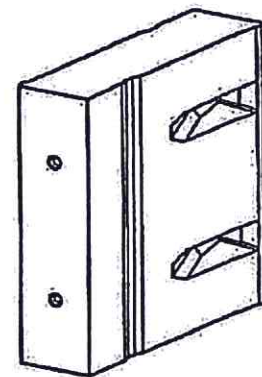
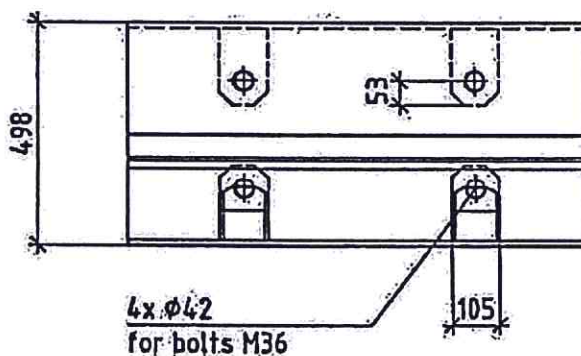
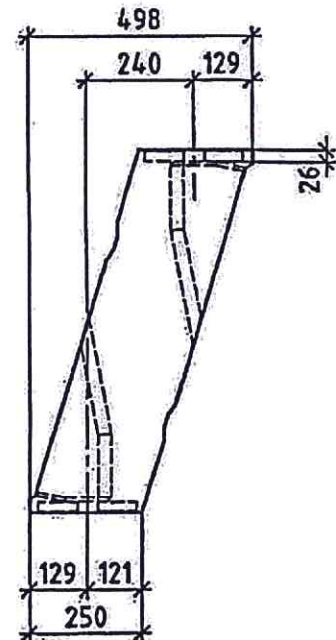
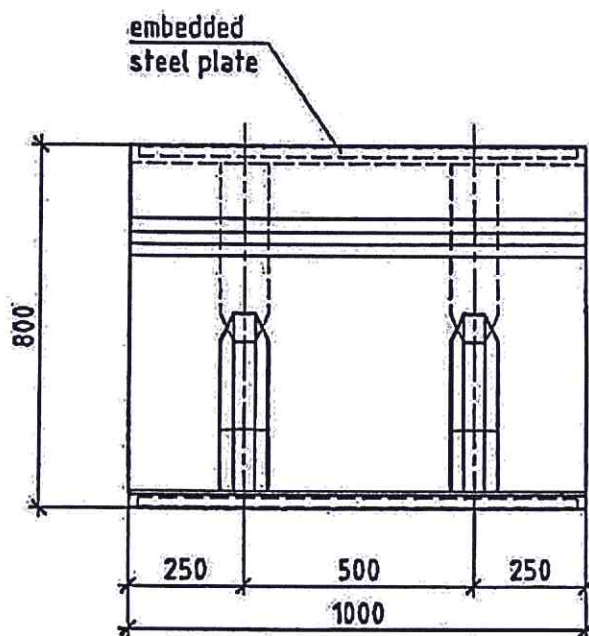

Performance data per element  
at 57.5% deflection:

Energy absorption: 151 kNm  
Reaction force: 408 kN  
Tolerance: +/-10%  
Material: NR/ SBR - SS400  
Weight approx: 268 kg  
Quantity: 8 elements

Pos. 1.1, 4x Special Washer for M36  
Ø80/38x8, St/hdg (1:5)

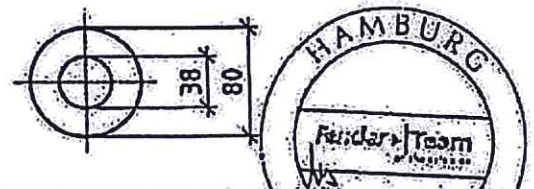

All tolerances acc. to Fenderteam catalogue edition 04/2011 - Alle Toleranzen gemäß Fenderteam-Katalog Ausgabe 04/2011

Project: Renovation of Pier 18, Ventspils  
FE 800 x 1000mm, G2.8  
Fender

© This drawing is the property of Fenderteam AG. It is not to be used for any other purpose without the written consent of Fenderteam AG. It shall not be copied or stored electronically without prior agreement of the owner.

**FenderTeam**

on the safe side

FenderTeam AG

Tarpen 40 - Haus 1b, 22419 Hamburg / Germany  
Tel. +49-(0)40-20 90 766 90, Fax +49-(0)40-20 90 766 90

**INGENIEURBÜRO  
ROßBURGER**

Dipl.-Ing. Peter Roßburger  
-Beratender Ingenieur für Bauwesen-

Tarpen 40 - Haus 1b, 22419 Hamburg / Germany  
Tel. +49-(0)40-20 90 766 90, info@rossburger.eu

Drawn:	AG	06.08.13
Designed:		03.11.11
Checked:	PR	06.08.13
Scale:	1:15, 1:5	Size: A4
Drawing-No.:	1907-001	